

# RMA-FS AND ASSOCIATED PARTS

## MATEABLE BULKHEAD CONNECTORS

**BULKHEAD CONNECTORS & MOUNTING REQUIREMENT**  
 (MATES TO RMA-FS & RMA-FS-R/A & RMA FS SL)  
 Dummy connector RMA FSD

Part Names: **XSC-BC, XSC-BCL**

Material: Glass Reinforced Epoxy

Contacts: Copper Alloy, Hard Gold Plated per ASTM-B-488

Pressure Rating, Mated: up to 10,000 psi

**XSC-BC, XSC-BCL;** These connectors feature a radial type o-ring seal, good for up to 10,000 PSI, mated. Available only in single contact.

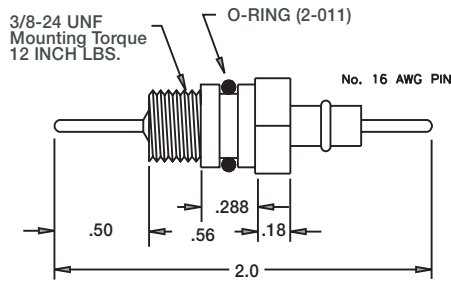

**XSC-BC**

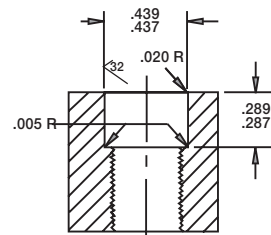
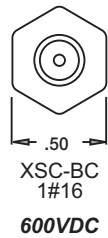

**3/8-24 UNF-2B THREAD MOUNTING REQUIREMENT**

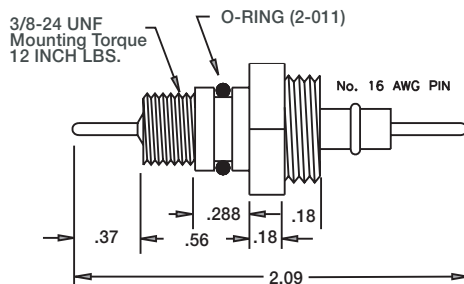

**XSC-BCL**



NOTE: Torque values referenced in this literature assume installation into dry metal threads. Please contact the factory for recommendations.